

Uran Thermo

Mineral wool



i Steel sheet sandwich panel with core mineral wool insulation, used where the non-combustibility of materials is required.

Applications for:
External cladding
Internal partitions
False ceilings.

Fast assembly and disassembly system thanks to the customised interlocking system.

Certifications

CE CE marking
in accordance with EN 14509

A2 Reaction to fire
class A2- s1- d0
in accordance with EN 13501-1

Use and characteristics

House icon Wall and false ceiling

Flame icon Non-combustible

Thermometer icon Thermal insulation

Options

Brackets icon Upper and lower profile customisable in material and shape for assembly requirements

Hand icon Upon request, internal fitting for technical equipment



M/F steel sheet

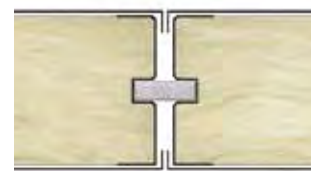

F/F steel sheet



F/F PVC *



F/F magnesium oxide

* The use of a PVC profile is limited to certain thicknesses.

Reference measurements*

Width	Length	Thickness
up to 3000 mm	10500 mm max	40 - 200 mm

* Size can be customised to prevent cuts and adjustments.

Uran Thermo - int./ext. steel sheet 0.45 mm core: MINERAL WOOL

thickness (mm)	40	50	55	60	80	100	125	150	175	200
weight (kg/m ²)	11.40	12.40	12.90	13.40	15.40	17.40	19.90	22.40	24.10	26.80
transmit. (W/m ² K)	0.89 - 0.83	0.73 - 0.68	0.67 - 0.62	0.62 - 0.58	0.48 - 0.44	0.38 - 0.36	0.31 - 0.29	0.26 - 0.24	0.21	0.18